



**LIBRARY  
DESIGN  
ASSOCIATES,  
INC.**



**E-MAILED**

10046 Brewster Lane  
Powell, Ohio 43065  
Telephone (614) 923-4600

Date 07/31/23  
Proposal No. P-39979  
Page 1

To **CHILLICOTHE & ROSS COUNTY PUBLIC LIBRARY**  
ATTN: JAMES HILL, DIRECTOR  
jhill@crepl.org

Item	Qty.	Catalog No.	Description	Unit Price	Total
1	1	LDA	<p>In accord with our recent phone conversation, it is my pleasure to submit the following proposal, for your consideration:</p> <p>New shelving and adjustable height staff tables for the Chillicothe and Ross County Public Library Annex Building. All product included is detailed as Item A.1 - B.1, on the attached LDA Schedule of Equipment and companion floor plan.</p> <p>To maximize freight and installer travel savings for the Library, all new shelving and staff tables will deliver together, to allow a single phase installation.</p> <p>Pricing above includes product freight and factory trained installation labor, by authorized LDA personnel.</p>	49,658.00	49,658.00

We propose to furnish the material specified above at the prices quoted under the conditions stated here. Deliveries are subject to delays from fire, strikes, other causes beyond our control.

Delivery F.O.B.

By Library Design Associates, Inc.

To order the items listed, merely sign and return, signifying your acceptance.

Accepted by/Title/Date



**LIBRARY  
DESIGN  
ASSOCIATES,  
INC.**

10046 Brewster Lane  
Powell, Ohio 43065  
Telephone (614) 923-4600

Date 07/31/23  
Proposal No. P-39979  
Page 2

To CHILLICOTHE & ROSS COUNTY PUBLIC LIBRARY  
ATTN: JAMES HILL, DIRECTOR  
jhill@crepl.org

Item	Qty.	Catalog No.	Description	Unit Price	Total
			<p>NOTES:</p> <p>a) Pricing listed above is F.O.B. Delivered and Installed by authorized Library Design Associates, Inc., personnel. Cost includes all labor and travel to complete this work.</p> <p>b) Aurora steel finish to be "#3000 Oyster". All finishes listed in the attached Schedule of Equipment.</p> <p>c) All Aurora and Worden product on this proposal has been quoted off the Ohio State Contract.</p> <p>d) Lead time for new product is (10-16) weeks after receipt of a purchase order and all finish selections.</p> <p>e) Pricing is based on the complete quantity as listed above. Should a purchase involving a reduced quantity be considered, please contact LDA to verify pricing prior to proceeding.</p>		

We propose to furnish the material specified above at the prices quoted under the conditions stated here. Deliveries are subject to delays from fire, strikes, other causes beyond our control.

Delivery F.O.B.

By Library Design Associates, Inc.

To order the items listed, merely sign and return, signifying your acceptance.

Accepted by/Title/Date



**LIBRARY  
DESIGN  
ASSOCIATES,  
INC.**

10046 Brewster Lane  
Powell, Ohio 43065  
Telephone (614) 923-4600

Date 07/31/23  
Proposal No. P-39979  
Page 3

To CHILLICOTHE & ROSS COUNTY PUBLIC LIBRARY  
ATTN: JAMES HILL, DIRECTOR  
jhill@crepl.org

Item	Qty.	Catalog No.	Description	Unit Price	Total
			<p>NOTES cont.:</p> <p>f) Please see the attached LDA layout and Schedule of Equipment, for additional details.</p> <p>g) Pricing is good for (30) days and is subject to reconfirmation thereafter.</p> <p>h) Payment terms are NET 30 days.</p> <p>The opportunity to submit this proposal is indeed appreciated. If any questions should arise, or if further information is required, please let me know. I look forward to continuing my work with you on this requirement.</p>		

We propose to furnish the material specified above at the prices quoted under the conditions stated here. Deliveries are subject to delays from fire, strikes, other causes beyond our control.

Delivered and Installed

Matt Baughman

Delivery F.O.B.

By Library Design Associates, Inc.

To order the items listed, merely sign and return, signifying your acceptance.

Accepted by/Title/Date



**LIBRARY DESIGN ASSOCIATES, INC.**  
10046 BREWSTER LANE POWELL, OH 43065  
TELEPHONE: (614) 923-4600  
[www.librarydesign.com](http://www.librarydesign.com)

Chillicothe and Ross County Public Library  
Annex Building – Outreach Layout  
Schedule Of Equipment  
July 31, 2023

**Section A – Steel Shelving**

Item: A.1

Qty: (7)

Description: Wall mount shelving sections, each to measure 90”H and will be constructed using new Aurora wall mount column strips. In each shelving section, LDA will install (3) existing 10”D or 12”D adjustable shelves. No corner filler will be utilized. This will allow space for book trucks to be parked below the adjustable shelves.

Item: A.2

Qty: (2)

Description: Single face sections of existing steel shelving, 90”H X 10”D X 36”W. Sections to be relocated from another area of the Annex.

Item: A.3

Qty: (18)

Description: Single face Aurora shelving sections, 90”H X 10/10”D X 36”W. Each section equipped with (1) 10”D integral back base shelf, (6) 10”D integral back adjustable shelves and (7) integral back sliding wire book supports. No end panels or steel tops have been included with this item. LDA will provide and install (1) new steel corner filler, to complete the installation.

Item: A.4

Qty: (19)

Description: Double face Aurora shelving sections, 90”H X 10/24”D X 36”W. Each section equipped with (1) 24”D integral back base shelf, (12) 10”D integral back adjustable shelves and (14) integral back sliding wire book supports. No end panels or steel tops have been included with this item.

**Section B – Technical Furniture**

Item: B.1

Qty: (2)

Description: "Gibraltar Series" adjustable height staff tables from The Worden Company, each to measure 30"D X 72"L. Both tables provided with a powdercoat steel "T-base", a hand-crank adjustable height mechanism and a plastic laminate top with PVC edging. Height adjustment for this table to range from 26-1/2"H to 39-3/4"H.

Steel Finish: Black

HPL/Matching PVC: Formica #8676-58 "Swede Rift Oak"

**NOTES:**

a) Aurora Steel Finish: "#3000 Oyster"

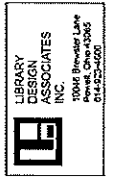
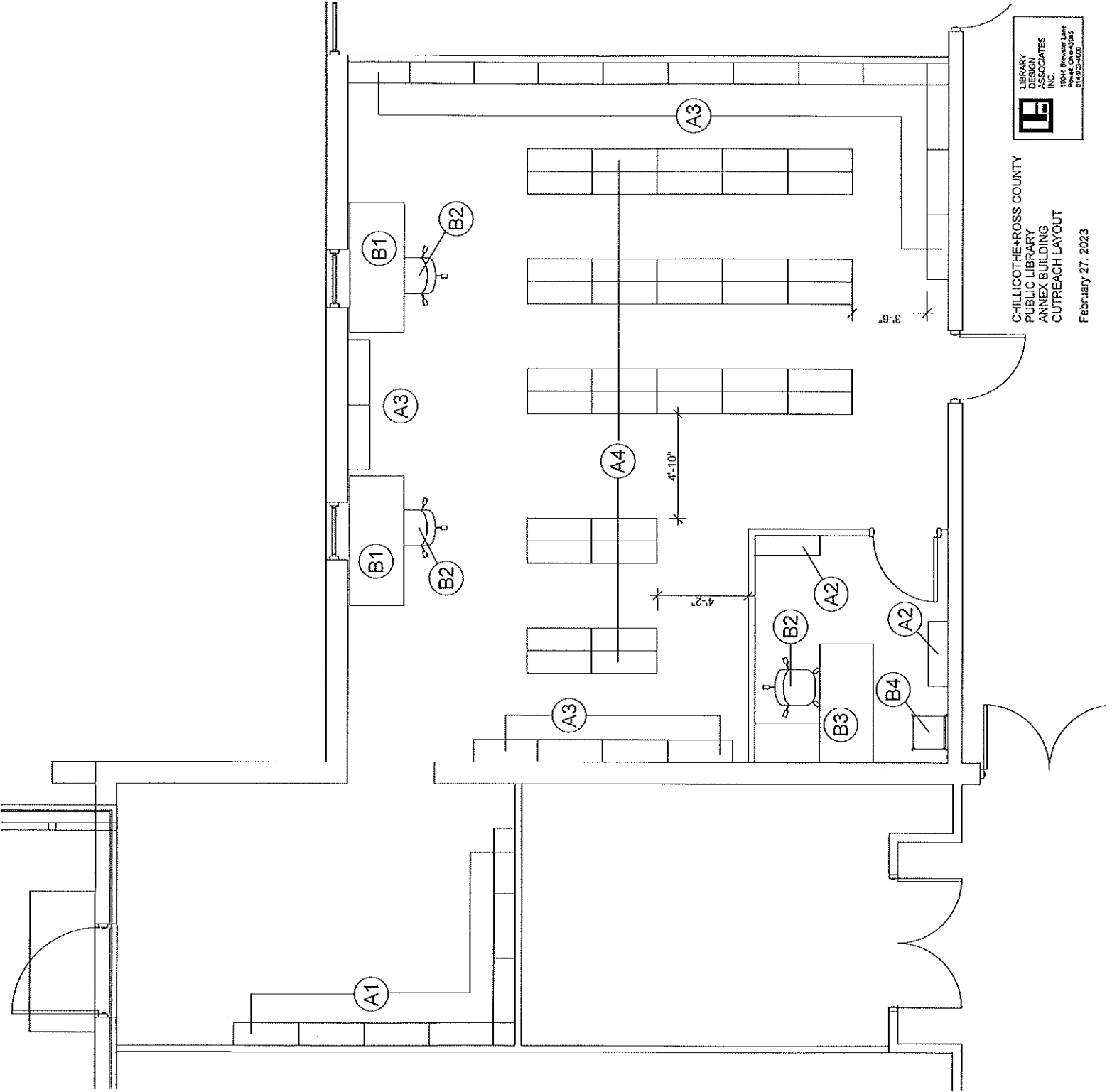

CHILICOTHE+ROSS COUNTY  
 PUBLIC LIBRARY  
 ANNEX BUILDING  
 OUTREACH LAYOUT  
 February 27, 2023